

45AD

45AD Dimensions

(Unit : mm)

(a) With 11kW Motor

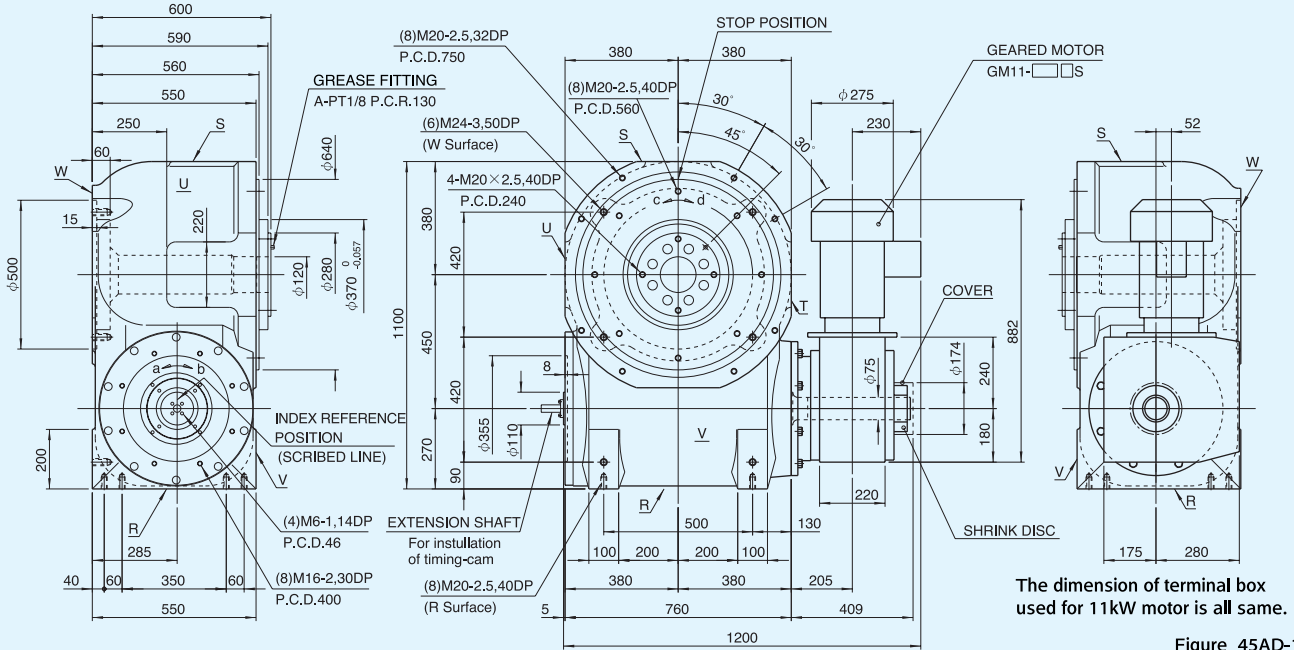

(b) With 15kW Motor

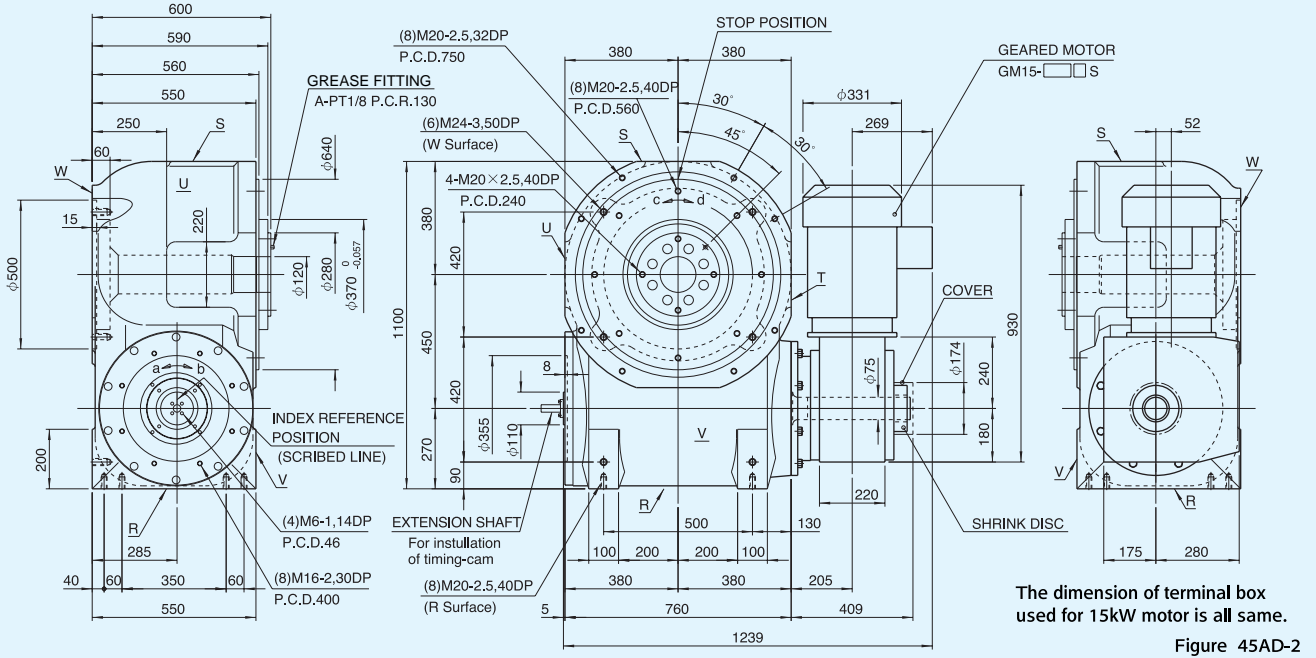

Specifications of indexing drive

Table 45AD-1

Item	Symbol	Unit	Value	Item	Symbol	Unit	Value	Item	Symbol	Unit	Value
Output allowable axial load	P ₁	N	47460	Input allowable axial load	P ₄	N	25100	Indexing accuracy (1 DWELL)		sec	± 20
Output allowable radial load	P ₂	N	40750	Input maximum repetitious bending force	P ₅	N	27000	Indexing accuracy (2 DWELL)		sec	± 40
Output static torque	T _s	N·m	Refer to Torque Capacity Table	Input maximum repetitious allowable torque	P ₆	N·m	8400	Repetitive accuracy		sec	20
Output torsional rigidity	K ₁	N·m/rad	3.18 × 10 ⁷	Input torsional rigidity	K ₂	N·m/rad	6.44 × 10 ⁵	Product weight (without reducer)		kg	1600
Output moment of inertia : J	J _o	kg·m ²	25.78	Input moment of inertia : J	J _c	kg·m ²	7.90	Housing color	Ivory		
Output allowable bending moment	P ₃	N·m	3070					Geared Motor color	2.2kW···Ivory 3.7kW···Aqua marine		

Note: Input moment of inertia : J is calculated in dwell.

1N·m≒0.102kgf·m

Specifications of geared motor

Table 45AD-2

Code		Motor Power (kW)	Actual Gear Ratio (i)	Output Shaft Speed N _M (rpm)		Output Allowable Torque T _R (N·m)		Moment of inertia J _M (kg·m ²)	Weight (kg)
200/220V	230V			50Hz	60Hz	50Hz	60Hz		
GM11-19.23AS-45AD	GM11-19.23BS-45AD	11	19.23	75	90	1320	1110	40.0×10 ⁻³	245
GM11-23.59AS-45AD	GM11-23.59BS-45AD		23.59	61	73	1610	1350		
GM11-26.39AS-45AD	GM11-26.39BS-45AD		26.39	55	66	1800	1510		
GM11-32.60AS-45AD	GM11-32.60BS-45AD		32.60	44	53	2160	1820		
GM11-36.05AS-45AD	GM11-36.05BS-45AD		36.05	40	48	2380	2000		
GM11-40.65AS-45AD	GM11-40.65BS-45AD		40.65	36	43	2680	2250		
GM11-44.89AS-45AD	GM11-44.89BS-45AD		44.89	32	39	2950	2480		
GM11-49.87AS-45AD	GM11-49.87BS-45AD		49.87	29	35	3270	2750		
GM15-9.55AS-45AD	GM15-9.55BS-45AD	15	9.55	153	183	890	745	92.5×10 ⁻³	310
GM15-15.42AS-45AD	GM15-15.42BS-45AD		15.42	95	114	1430	1200		
GM15-21.23AS-45AD	GM15-21.23BS-45AD		21.23	69	82	1970	1640		
GM15-26.39AS-45AD	GM15-26.39BS-45AD		26.39	55	66	2430	2040		
GM15-32.60AS-45AD	GM15-32.60BS-45AD		32.60	45	54	2920	2450		
GM15-36.05AS-45AD	GM15-36.05BS-45AD		36.05	41	49	3230	2700		
GM15-40.65AS-45AD	GM15-40.65BS-45AD		40.65	36	43	3630	3040		
GM15-44.89AS-45AD	GM15-44.89BS-45AD		44.89	33	39	4000	3350		

Torque limiter mounting specifications (option)

Figure 45AD-3

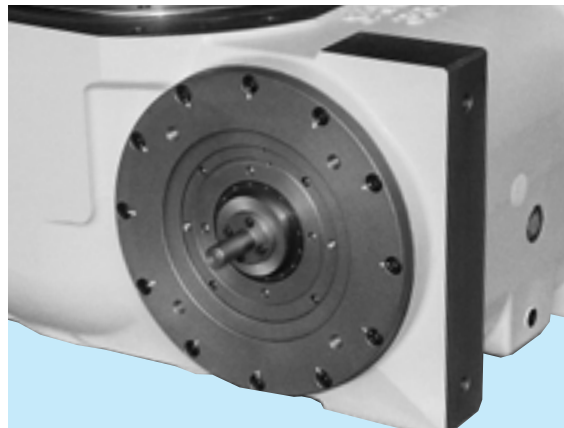
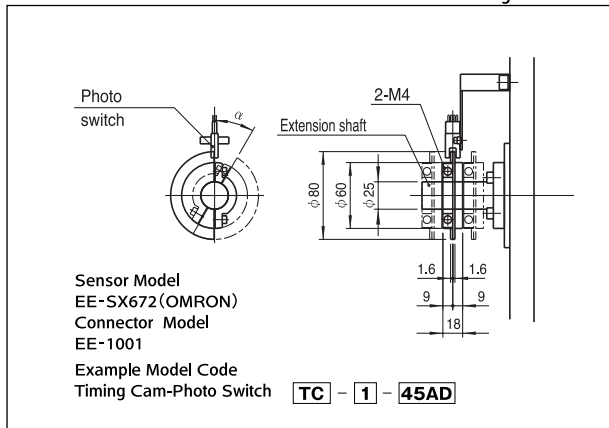

Mounting extended shaft

Precautions

- The dimension drawing(Figure 45AD-1, 45AD-2) shows the standard mounting position for geared motor.
- Model 45AD can be equipped with 11kW and 15kW motor. 18.5kW motor is also available as special instructions.
- Up to 3 sets of timing cams and photo switches can be added as necessary.
- The timing cam can be freely adjusted to any period(α)below 180°.

Standard input shaft (T surface side)

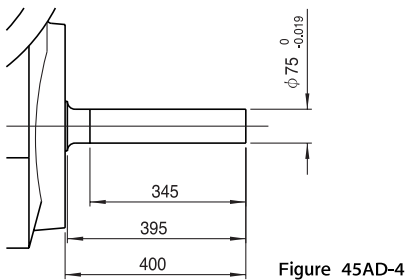

Output fixed flange specifications

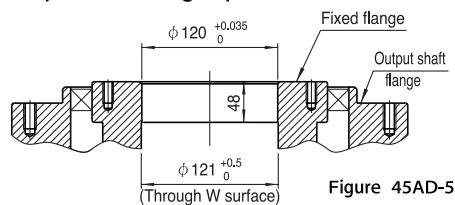

Locations of oil plug, etc., and oil capacity

Figure 45AD-6

Mounting position	1	2	5
Location			
Oil capacity(ℓ)	115	105	115

Precautions

- Each point indicated in the mounting positions shown in Figure 45AD-6 represents (starting at top) the oil plug (PT1), oil level (VB), and drain (PT1).
- The mounting positions correspond to code i for the indexing drives.
- The oil capacities indicated in Figure 45AD-6 are given in general figures and will differ according to the profile of the cam and the number of cam followers.